

11/14/11
 #5, 6, 7, 8 + 10 are available

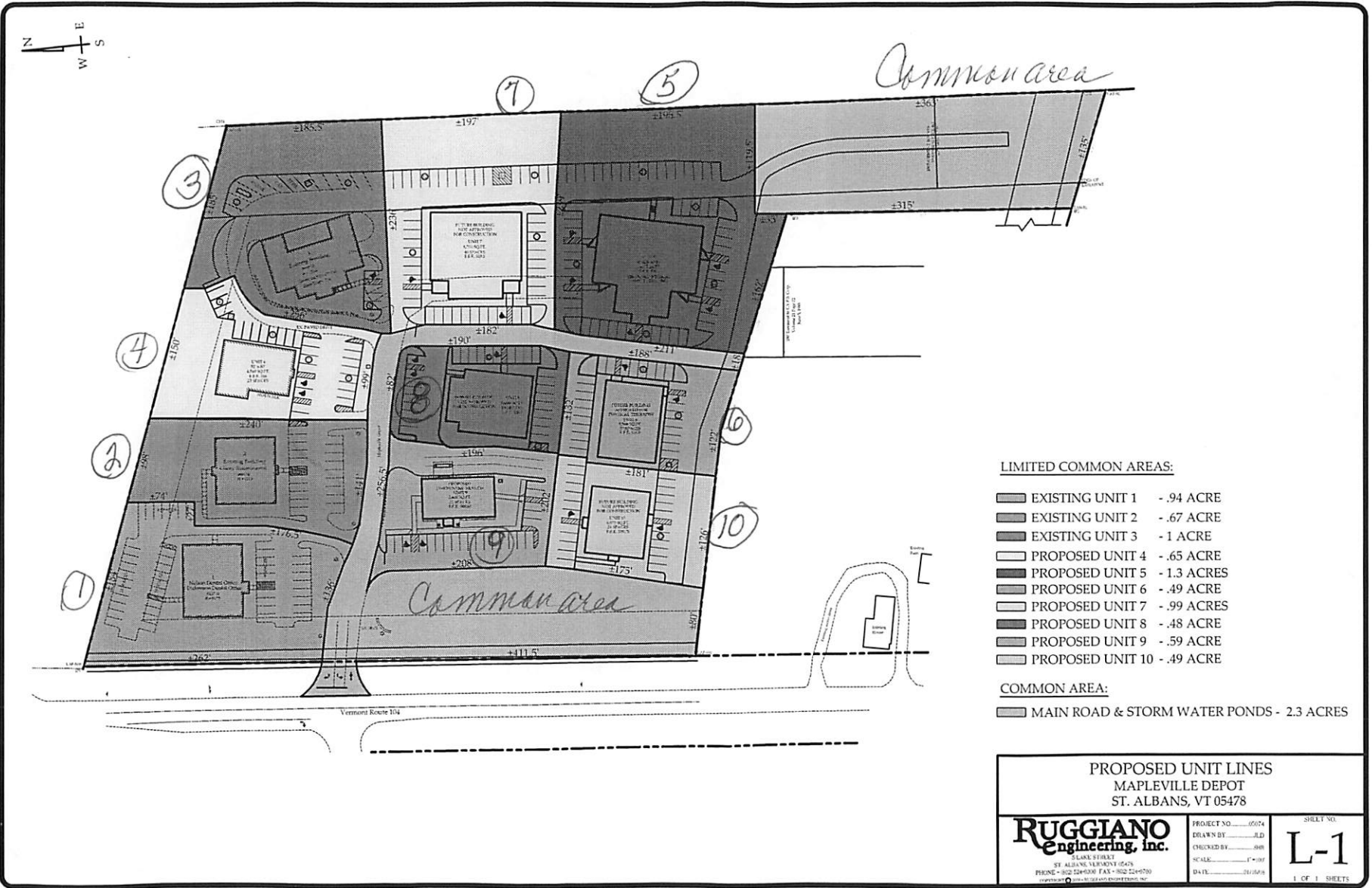

LIMITED COMMON AREAS:

- EXISTING UNIT 1 - .94 ACRE
- EXISTING UNIT 2 - .67 ACRE
- EXISTING UNIT 3 - 1 ACRE
- PROPOSED UNIT 4 - .65 ACRE
- PROPOSED UNIT 5 - 1.3 ACRES
- PROPOSED UNIT 6 - .49 ACRE
- PROPOSED UNIT 7 - .99 ACRES
- PROPOSED UNIT 8 - .48 ACRE
- PROPOSED UNIT 9 - .59 ACRE
- PROPOSED UNIT 10 - .49 ACRE

COMMON AREA:

- MAIN ROAD & STORM WATER PONDS - 2.3 ACRES

PROPOSED UNIT LINES MAPLEVILLE DEPOT ST. ALBANS, VT 05478		
RUGGIANO <i>Engineering, Inc.</i> <small>10 LAKE STREET ST. ALBANS, VERMONT 05478 PHONE: (802) 244-0300 FAX: (802) 244-0570 COPYRIGHT © 2011 RUGGIANO ENGINEERING, INC.</small>	PROJECT NO. 05074 DRAWN BY: J.D. CHECKED BY: J.M. SCALE: 1"=100' DATE: 01/15/11	SHEET NO. L-1 1 OF 1 SHEETS